

Purge Gas Valve Adapter Set

edwardsvacuum.com

Scope of this addendum

Please read this addendum in conjunction with the following instruction manual:

Title	Publication number	Link
nEXT2807M - nEXT3207M	301253274	https://4vac.io/2y1nu5

The section and table headings in this document refer to the section and table headings in the instruction manual.

Overview

Description

The adapter set serves as a connecting component when fitting a purge gas valve.

Supplied Equipment

- Purge gas adapter with O-ring.

Required Tools

- Hexagon socket screw key M8
- Torque wrench M17

Installation



CAUTION:

Note the safety information provided in the Operating Instructions for the pump.

1. Remove the locking screw 6531773 along with its O-ring (YTZ500292) with the hexagon socket screw key. Refer [Figure 1](#) on page 2.
2. Install the purge gas adapter and the new O-ring with the torque wrench (M17). Tightening torque for the adapter: 11 Nm \pm 5 %. Refer [Figure 2](#) on page 2.

Figure 1 Removing locking screw and O-ring

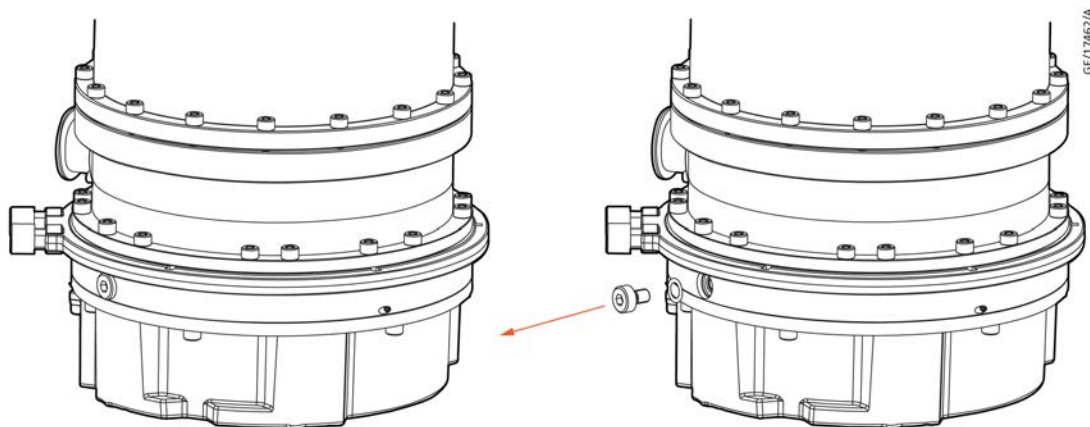
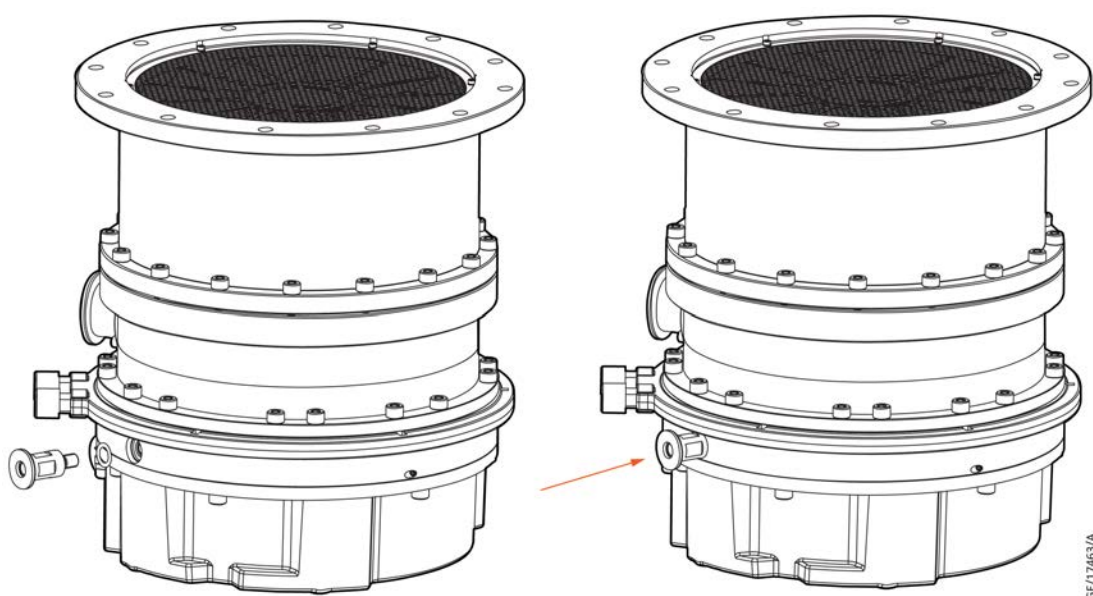

Figure 2 Installing the adapter



Recommended accessories for the DN10 ISO KF connection

- Centering ring DN10 ISO-KF (Part No. C10511395)
- Adapter centering ring DN10/16 ISO-KF (Part No. C10512345)
- Clamping ring DN10/16 ISO-KF (Part No. C10512403)
- Clamped quick release ring DN10/16 ISO-KF (Part No. C10512402)

Recommended valves (e.g.)

- Purge gas valve w/ glass capillary 36 sccm / 1 - 1.5 bar (Part No. B8G200851)
- Purge gas valve 36 sccm / 24V / 1.5 – 6 bar (Part No. B8G200850)